

Installation of MTP fiber cable inside YE1 Patch panel

Andrés Leonardo Cabrera Mora

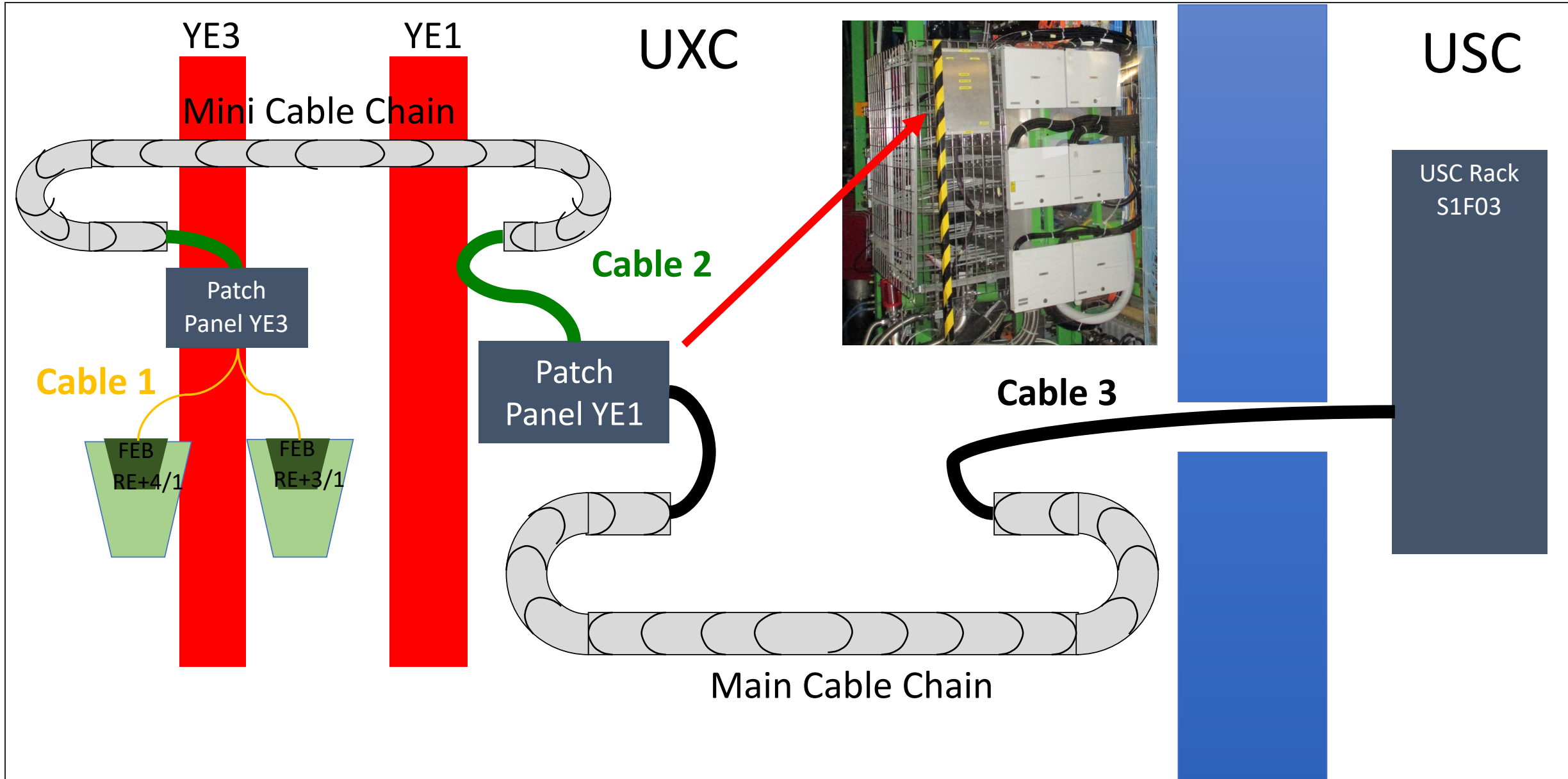

Sketch of the complete fiber optic installation



YE+1 Patch pannel

YE+1 Patch pannel
RPC Optical Fiber Box

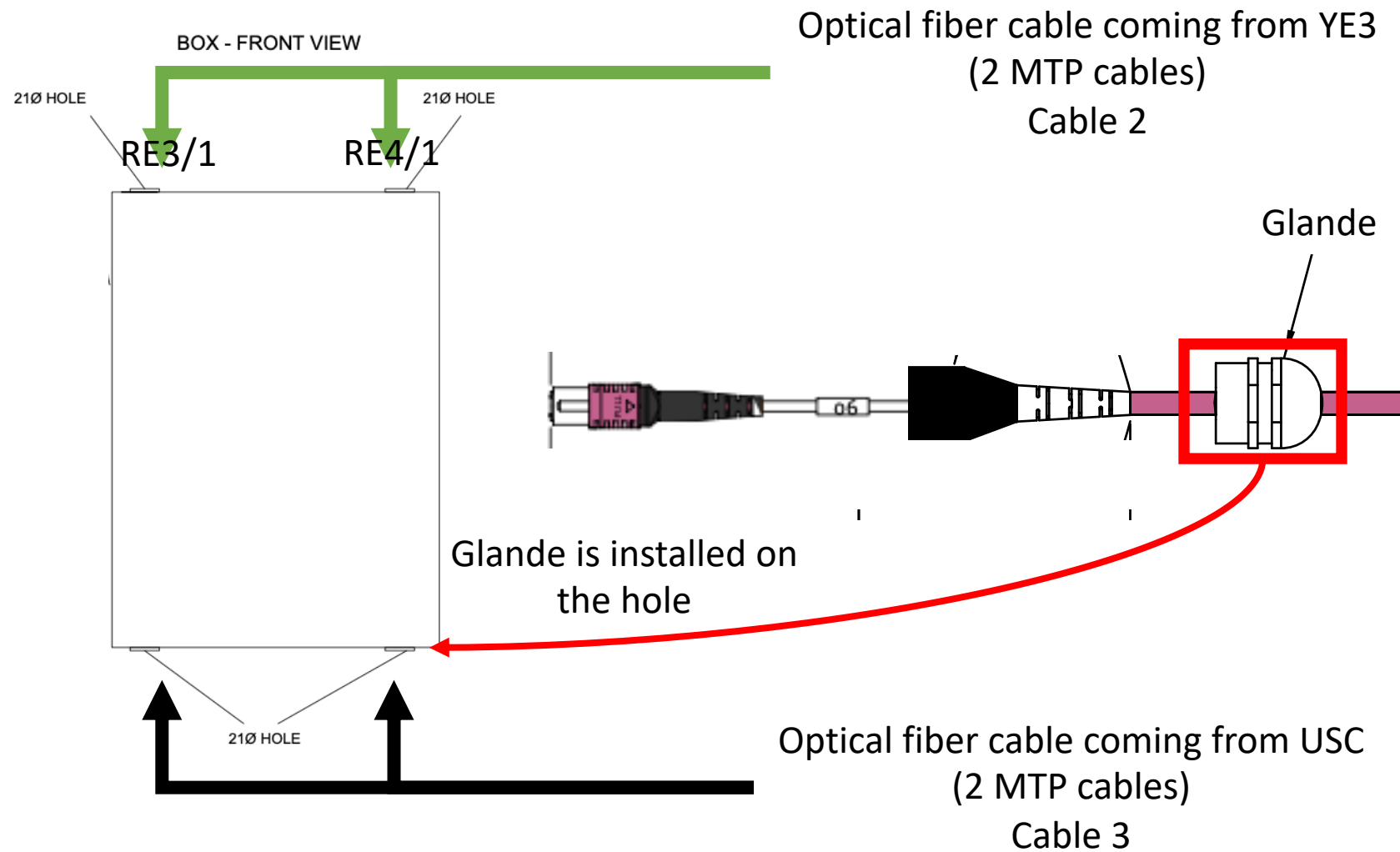

Fixing the gland with the nut in the hole of the box

Step 1

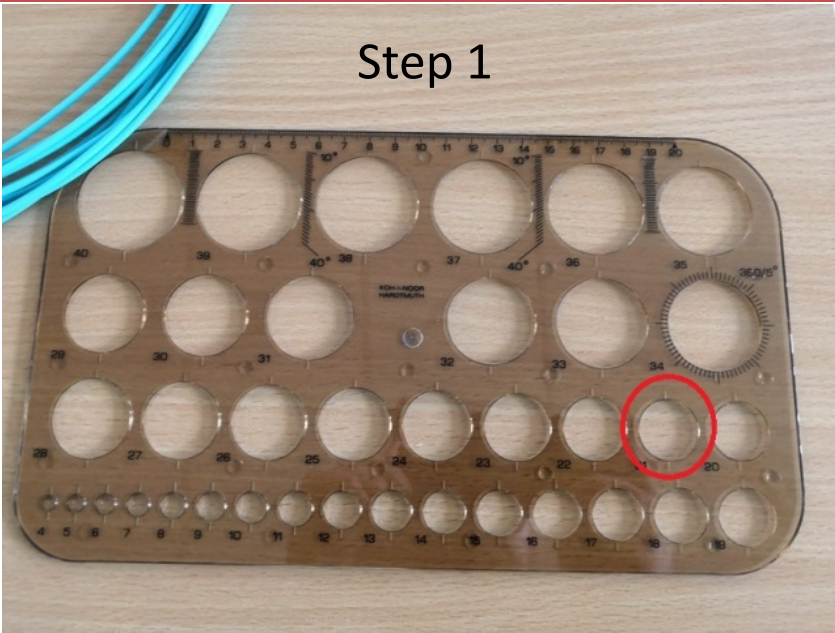

Step 2

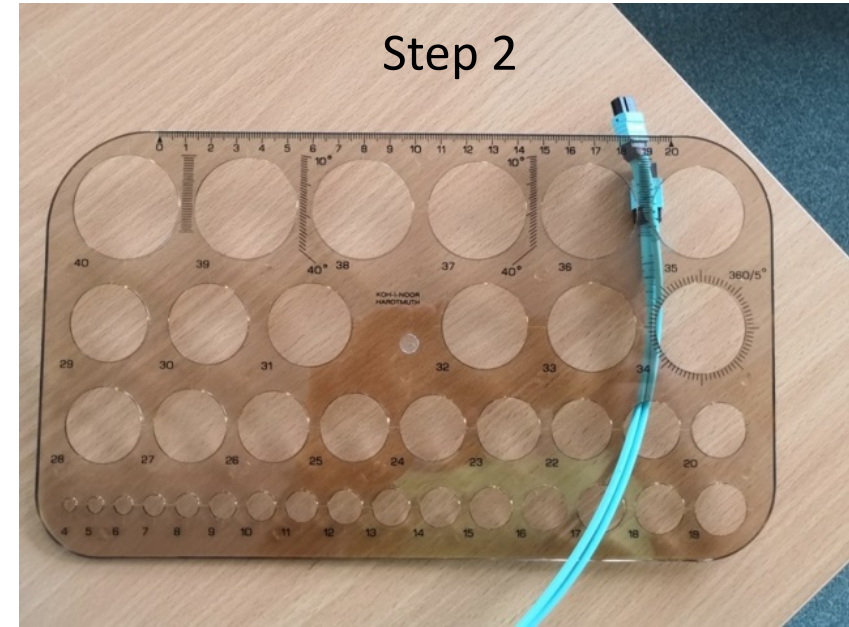

Step 3

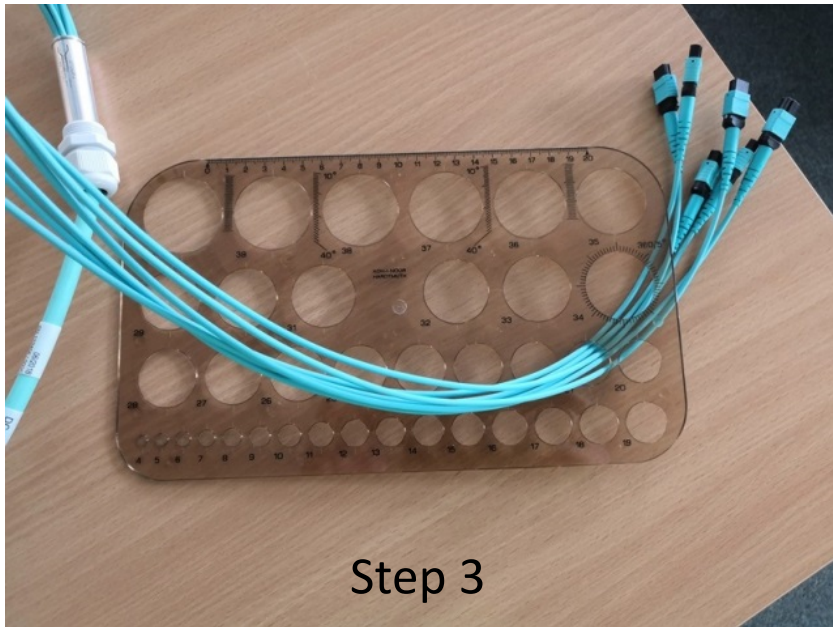

Step 4

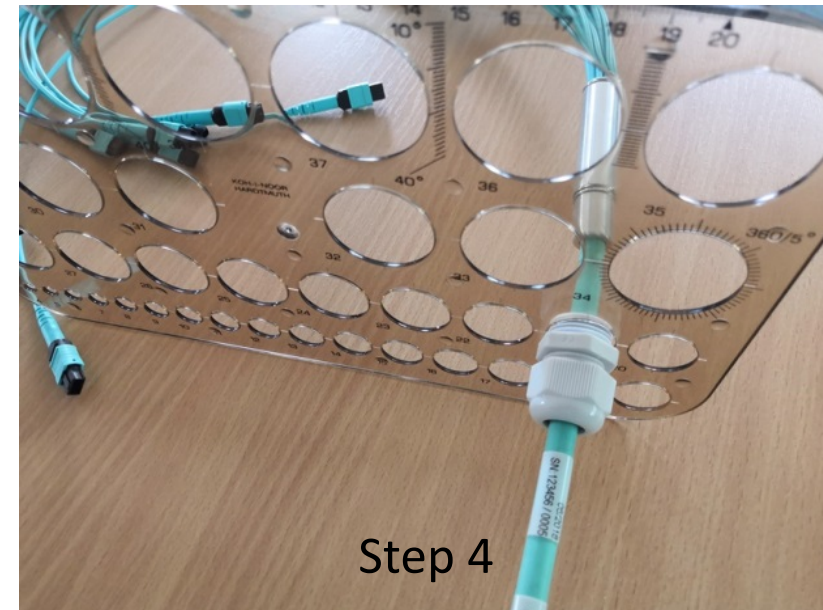

Fixing the gland with the nut in the hole of the box

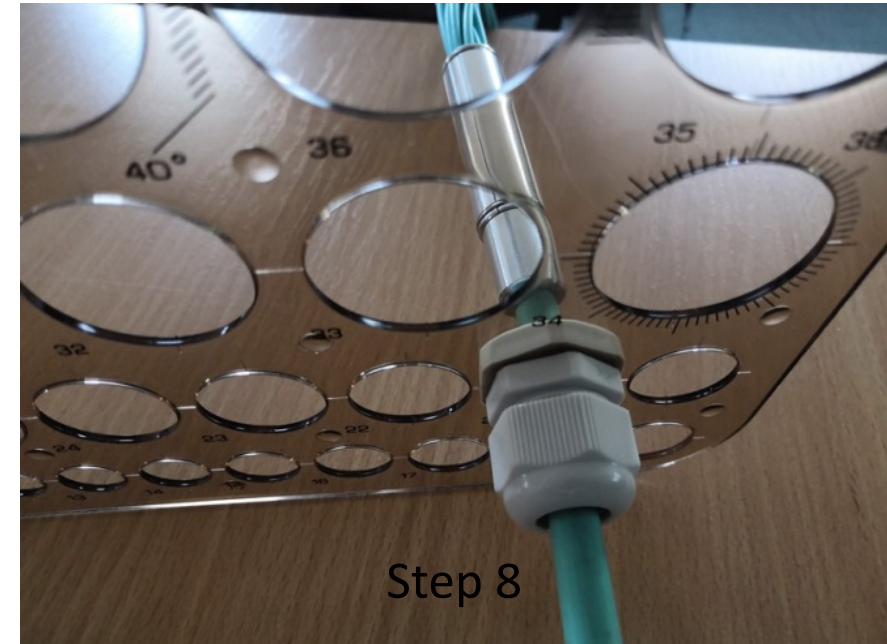
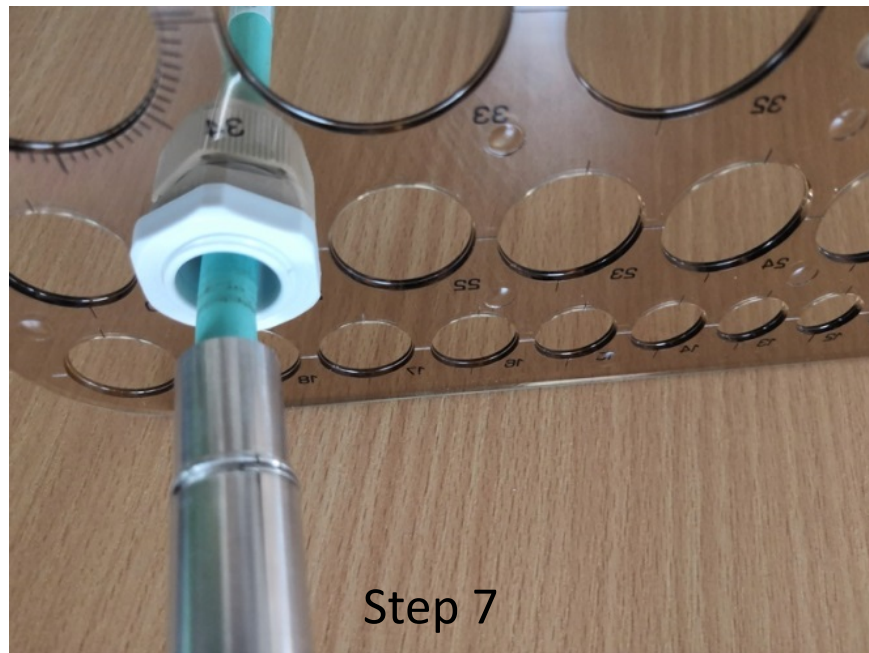
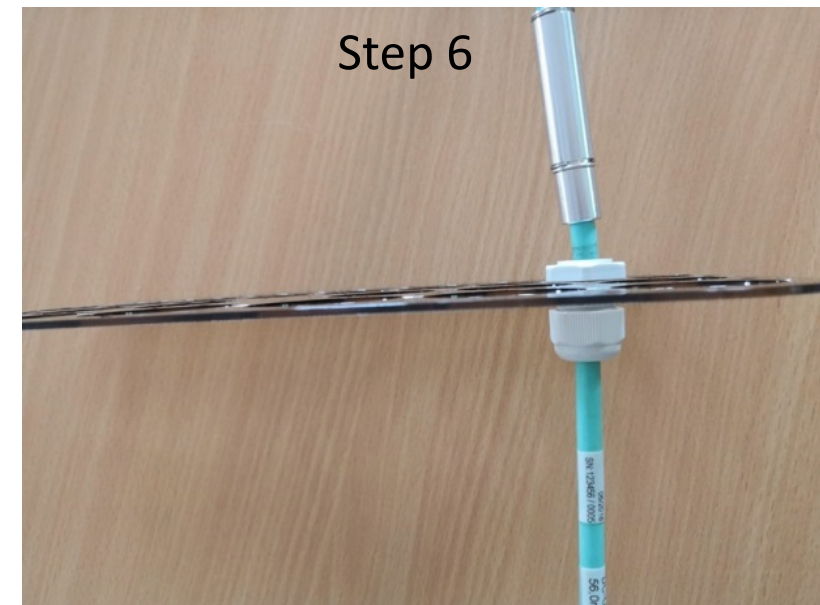
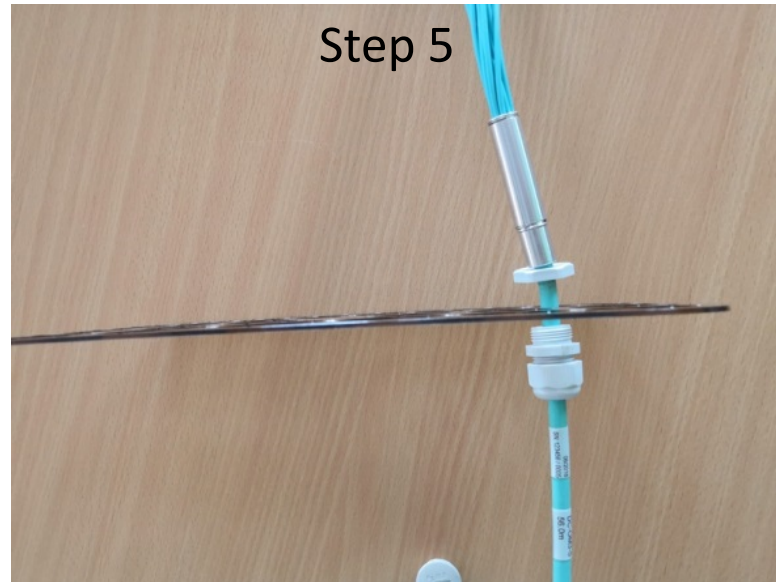

MTP array to be fixed in the center of the box



MTP array with 12 MTP adapters fixed to the center of the box

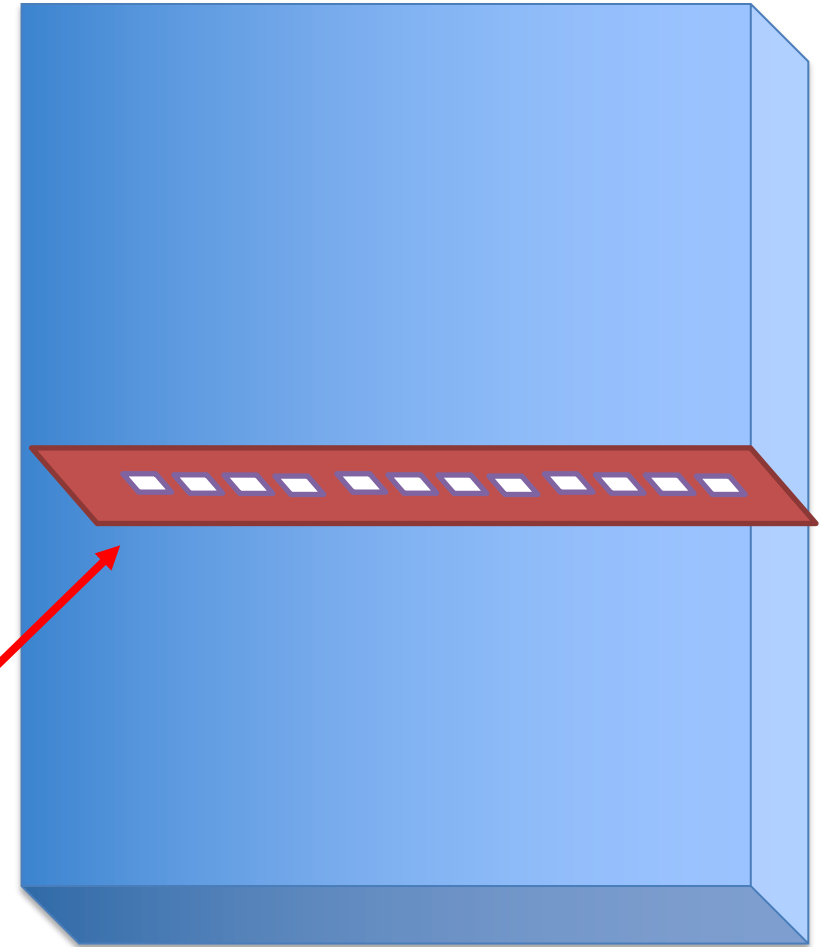

Arranging the fiber cable in loops

Arrange the fiber cable in loops passing the cables through the plastic pieces (which must be fixed to the box)

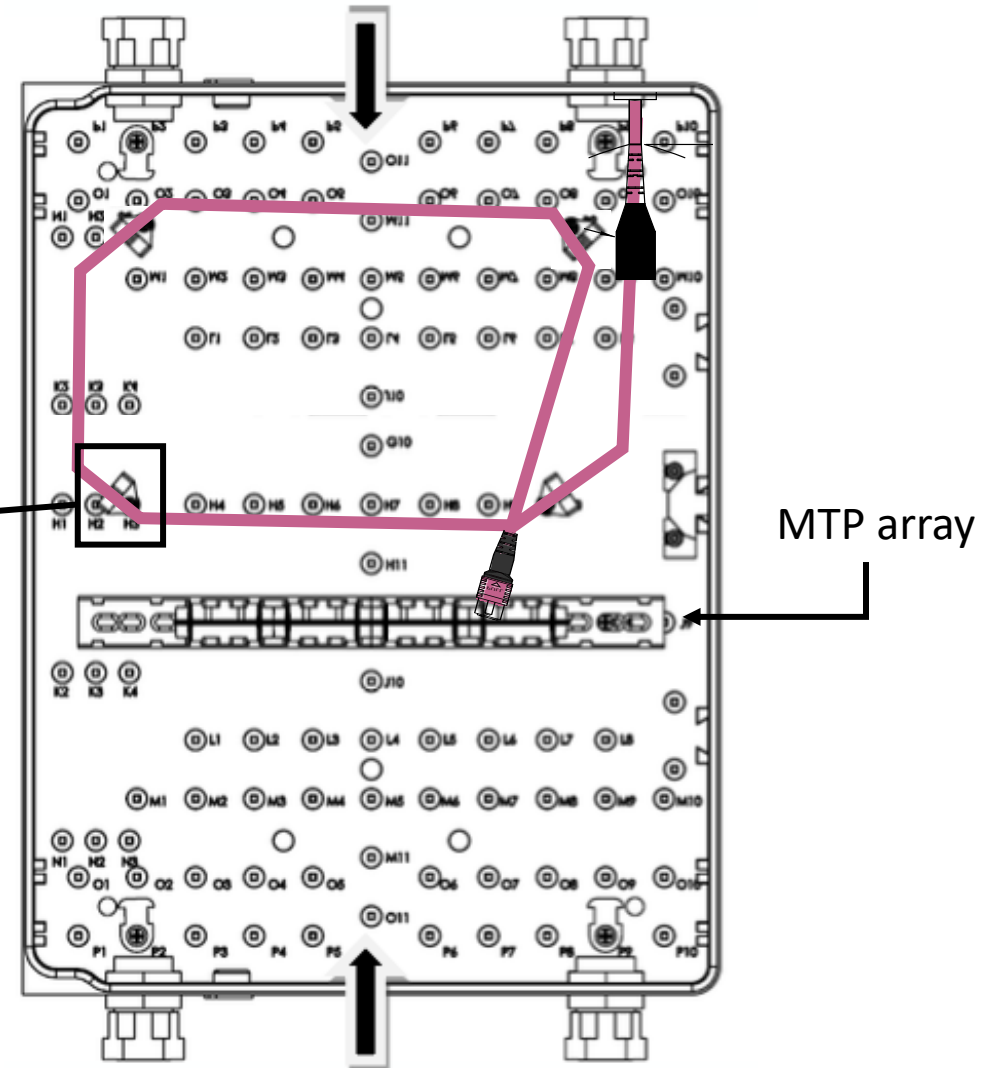

Connection MTP male-female 01 -> 01 and so on...



Each MTP connector must be carefully cleaned with a reel cleaner before connecting.

