

PORT CONNECTOR | APS

APPLICATION

Converts a female tube fitting end to a male tube stem of the same diameter.

Special requirements on request

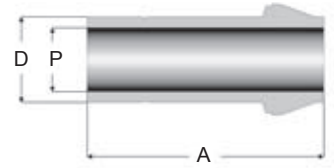

TUBE SIZE - METRIC (mm)

D	Reference	A	P
3	APS* 3	23,0	1,8
4	APS* 4	23,8	2,4
6	APS* 6	26,2	4
8	APS* 8	27,0	6
10	APS* 10	27,8	7,5
12	APS* 12	38,1	9,5
14	APS* 14	38,1	11
16	APS* 16	38,1	13
18	APS* 18	38,1	15
20	APS* 20	41,9	16

*Specify material when ordering. See page 8 for materials and codes.

TUBE SIZE - FRACTIONAL (inch)

D	Reference	A	P
1/16"	APS* 1/16	0.66	1/32"
1/8"	APS* 1/8	0.91	5/64"
3/16"	APS* 3/16	0.94	3/32"
1/4"	APS* 1/4	1.03	3/16"
5/16"	APS* 5/16	1.16	1/4"
3/8"	APS* 3/8	1.06	15/64"
1/2"	APS* 1/2	1.50	3/8"
5/8"	APS* 5/8	1.50	1/2"
3/4"	APS* 3/4	1.50	5/8"

Hex flats (H) are metric. Fractional upon request
*Specify material when ordering. See page 8 for materials and codes.

REDUCING PORT CONNECTOR | APRS

APPLICATION

Converts a female tube fitting end to a male tube stem of a different diameter.

Special requirements on request

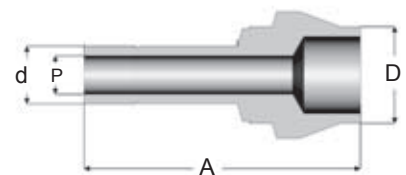

TUBE SIZE - METRIC (mm)

D	d	Reference	A	P
4	3	APRS* 4 3	26,2	2,4
6	3	APRS* 6 3	26,2	2,4
6	4	APRS* 6 4	27,0	3,2
8	6	APRS* 8 6	27,8	4,8
10	6	APRS* 10 6	28,6	4,8
10	8	APRS* 10 8	30,3	6
12	6	APRS* 12 6	36,9	4,8
12	8	APRS* 12 8	37,6	6
12	10	APRS* 12 10	38,1	7,9
18	12	APRS* 18 12	44,1	9,5
20	12	APRS* 20 12	44,1	9,5

*Specify material when ordering. See page 8 for materials and codes.

TUBE SIZE - FRACTIONAL (inch)

D	d	Reference	A	P
1/8"	1/16"	APRS* 1/8 1/16	0.81	3/64"
1/4"	1/16"	APRS* 1/4 1/16	0.84	3/64"
1/4"	1/8"	APRS* 1/4 1/8	1.03	3/32"
1/4"	3/16"	APRS* 1/4 3/16	1.06	1/8"
5/16"	1/4"	APRS* 5/16 1/4	1.09	3/16"
3/8"	1/16"	APRS* 3/8 1/16	0.84	3/64"
3/8"	1/8"	APRS* 3/8 1/8	1.03	3/32"
3/8"	1/4"	APRS* 3/8 1/4	1.13	3/16"
1/2"	1/4"	APRS* 1/2 1/4	1.45	3/16"
1/2"	3/8"	APRS* 1/2 3/8	1.50	9/32"
3/4"	1/2"	APRS* 3/4 1/2	1.73	13/32"

Hex flats (H) are metric. Fractional upon request
*Specify material when ordering. See page 8 for materials and codes.

REDUCER | ADRS

APPLICATION

Converts a tube of one diameter to a tube stem of a larger or smaller diameter.

Special requirements on request

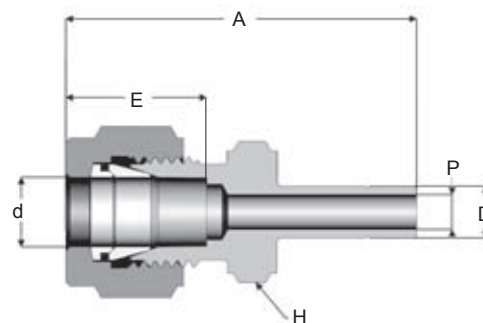

TUBE SIZE - METRIC (mm)

d	D	Reference	A	E	H	P
3	4	ADRS* 3 4	34,4	12,9	8	2,0
3	6	ADRS* 3 6	36,1	12,9	8	2,0
3	8	ADRS* 3 8	36,8	12,9	12	2,0
3	10	ADRS* 3 10	37,6	12,9	12	2,0
4	6	ADRS* 4 6	36,8	13,7	12	3,0
4	8	ADRS* 4 8	37,6	13,7	12	3,0
6	3	ADRS* 6 3	36,8	15,3	14	1,8
6	4	ADRS* 6 4	37,6	15,3	14	2,4
6	6	ADRS* 6 6	39,2	15,3	14	4,0
6	8	ADRS* 6 8	40,1	15,3	14	4,0
6	10	ADRS* 6 10	40,7	15,3	14	4,5
6	12	ADRS* 6 12	46,3	15,3	14	4,5
8	6	ADRS* 8 6	40,4	16,2	14	4,0
8	10	ADRS* 8 10	42,0	16,2	14	6,4
8	12	ADRS* 8 12	47,6	16,2	14	9,5
10	6	ADRS* 10 6	42,4	17,2	17	4,0
10	8	ADRS* 10 8	42,5	17,2	17	6,0
10	12	ADRS* 10 12	48,9	17,2	17	8,0
10	18	ADRS* 10 18	51,3	17,2	22	8,0
10	22	ADRS* 10 22	52,1	17,2	24	8,0
12	6	ADRS* 12 6	45,0	22,8	22	4,0
12	10	ADRS* 12 10	46,6	22,8	22	7,5
12	16	ADRS* 12 16	53,8	22,8	22	9,5
12	18	ADRS* 12 18	53,8	22,8	22	9,5
12	25	ADRS* 12 25	60,1	22,8	24	9,5
16	12	ADRS* 16 12	53,0	24,4	24	13,0
16	18	ADRS* 16 18	54,6	24,4	24	13,0
18	12	ADRS* 18 12	55,4	24,4	27	9,5
18	16	ADRS* 18 16	56,9	24,4	27	13,0
18	22	ADRS* 18 22	56,9	24,4	27	15,0
18	25	ADRS* 22 20	64,1	24,4	27	15,0
22	20	ADRS* 22 20	61,7	24,4	30	19,1
22	25	ADRS* 22 25	64,9	24,4	30	19,1

*Specify material when ordering. See page 8 for materials and codes.

TUBE SIZE - FRACTIONAL (inch)

d	D	Reference	A	E	H (mm)	P
1/16"	1/8"	ADRS* 1/16" 1/8"	1.10	0.34	8	1/16"
1/8"	1/8"	ADRS* 1/8" 1/8"	1.29	0.5	8	1/16"
1/8"	3/16"	ADRS* 1/8" 3/16"	1.32	0.5	8	5/64"
1/8"	1/4"	ADRS* 1/8" 1/4"	1.39	0.5	8	5/64"
3/16"	1/8"	ADRS* 3/16" 1/8"	1.31	0.54	12	1/16"
3/16"	1/4"	ADRS* 3/16" 1/4"	1.41	0.54	12	1/8"
1/4"	1/8"	ADRS* 1/4" 1/8"	1.41	0.6	14	1/16"
1/4"	3/16"	ADRS* 1/4" 3/16"	1.44	0.6	14	3/16"
1/4"	1/4"	ADRS* 1/4" 1/4"	1.50	0.6	14	5/32"
1/4"	5/16"	ADRS* 1/4" 5/16"	1.54	0.6	14	3/16"
1/4"	3/8"	ADRS* 1/4" 3/8"	1.57	0.6	14	3/16"
1/4"	1/2"	ADRS* 1/4" 1/2"	1.79	0.6	14	3/16"
1/4"	3/4"	ADRS* 1/4" 3/4"	1.97	0.6	22	3/16"
1/4"	5/8"	ADRS* 1/4" 5/8"	1.89	0.6	17	3/16"
5/16"	3/8"	ADRS* 5/16" 3/8"	1.58	0.64	14	1/4"
5/16"	1/2"	ADRS* 5/16" 1/2"	1.80	0.64	14	1/4"
3/8"	1/4"	ADRS* 3/8" 1/4"	1.59	0.66	17	5/32"
3/8"	3/8"	ADRS* 3/8" 3/8"	1.65	0.66	17	9/32"
3/8"	1/2"	ADRS* 3/8" 1/2"	1.87	0.66	17	9/32"
3/8"	5/8"	ADRS* 3/8" 5/8"	1.94	0.66	19	9/32"
3/8"	3/4"	ADRS* 3/8" 3/4"	2.02	0.66	22	9/32"
1/2"	1/4"	ADRS* 1/2" 1/4"	1.78	0.9	22	5/32"
1/2"	3/8"	ADRS* 1/2" 3/8"	1.83	0.9	22	9/32"
1/2"	1/2"	ADRS* 1/2" 1/2"	1.06	0.9	22	3/8"
1/2"	5/8"	ADRS* 1/2" 5/8"	2.13	0.9	22	3/8"
1/2"	3/4"	ADRS* 1/2" 3/4"	2.13	0.9	22	3/8"
5/8"	3/8"	ADRS* 5/8" 3/8"	1.88	0.96	24	9/32"
5/8"	1/2"	ADRS* 5/8" 1/2"	2.10	0.96	24	3/8"
5/8"	3/4"	ADRS* 5/8" 3/4"	2.16	0.96	24	1/2"
5/8"	7/8"	ADRS* 5/8" 7/8"	1.29	0.96	24	1/2"
5/8"	1"	ADRS* 5/8" 1"	2.45	0.96	27	1/2"
3/4"	1/2"	ADRS* 3/4" 1/2"	2.14	0.96	27	3/8"
3/4"	1"	ADRS* 3/4" 1"	2.48	0.96	27	5/8"

Hex flats (H) are metric. Fractional upon request
*Specify material when ordering. See page 8 for materials and codes.

HEAT EXCHANGER REDUCER | ADTS

For ordering use ADTS instead of ADRS

Same as the ADRS with a straight bore-through to accommodate heat exchanger and sensor apparatus.

Special requirements on request

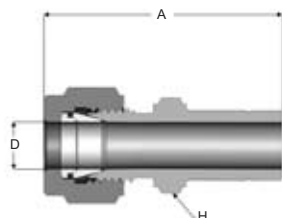

BULKHEAD REDUCER | UCAS

APPLICATION

Converts a tube fitting end to a tube stem through a wall panel. The tube stem is useful to set the direction through a panel construction.

Special requirements on request

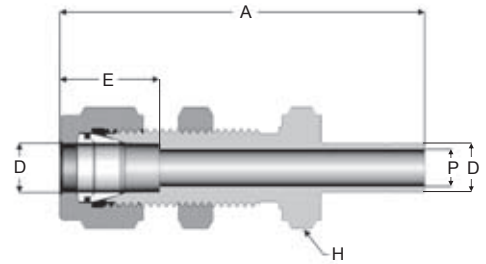

TUBE SIZE - METRIC (mm)

D	Reference	A	E	H	P	B'Head Hole Drill Size	MA. B'Head Thick.
3	UCAS* 3	50,2	12,9	14	1,8	8,3	12,7
4	UCAS* 4	51,9	13,7	14	2,4	9,8	12,7
6	UCAS* 6	55,8	15,3	17	4,8	11,5	10,3
8	UCAS* 8	59,1	16,2	17	6,4	13,1	11,1
10	UCAS* 10	61,6	17,2	22	7,5	16,3	11,1
12	UCAS* 12	72,8	22,8	24	9,5	19,5	12,7
14	UCAS* 14	75,2	24,4	27	11,0	21,0	12,7
16	UCAS* 16	76,8	24,4	27	12,7	22,5	12,7
18	UCAS* 18	83,1	24,4	30	12,7	26,0	16,7
20	UCAS* 20	83,9	26,0	32	15,9	29,0	19,1
22	UCAS* 22	90,3	26,0	36	18,5	29,0	20,6
25	UCAS* 25	101,1	31,3	38	22,0	33,8	23,8

*Specify material when ordering. See page 8 for materials and codes.

TUBE SIZE - FRACTIONAL (inch)

D	Reference	A	E	H (mm)	P	B'Head Hole Drill Size	MA. B'Head Thick.
1/8"	UCAS* 1/8	1.98	0.5	14	1/32"	21/64"	1/2"
1/4"	UCAS* 1/4	2.20	0.6	17	3/16"	29/64"	17/32"
3/8"	UCAS* 3/8	2.42	0.66	22	1/8"	37/64"	9/16"
1/2"	UCAS* 1/2	2.86	0.9	24	3/8"	49/64"	19/32"
5/8"	UCAS* 5/8	3.02	0.96	27	1/2"	57/64"	19/32"
3/4"	UCAS* 3/4	3.27	0.96	30	5/8"	1 1/64"	25/32"
1"	UCAS* 1"	3.98	1.23	38	7/8"	1 21/64"	15/16"

Hex flats (H) are metric. Fractional upon request
*Specify material when ordering. See page 8 for materials and codes.

CONVERTING REDUCER | AMOD

APPLICATION

Converts a metric tube to a fractional tube stem or vice-versa.

Special requirements on request

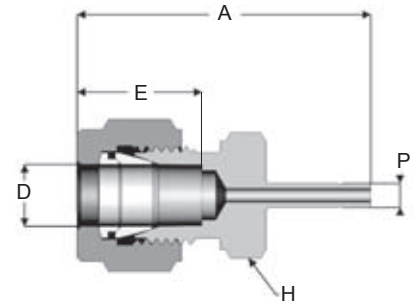

TUBE SIZE - METRIC TO FRACTIONAL - (mm)

d	D	Reference	A	E	H	P
3	1/8"	AMOD* 3 1/8	33,6	12,9	12	2,4
3	1/4"	AMOD* 3 1/4	34,4	12,9	12	2,4
4	1/4"	AMOD* 4 1/4	36,8	13,7	12	3,2
6	1/8"	AMOD* 6 1/8	36,8	15,3	14	4,8
6	1/4"	AMOD* 6 1/4	37,6	15,3	14	4,8
6	5/16"	AMOD* 6 5/16	40,2	15,3	14	4,8
6	3/8"	AMOD* 6 3/8	40,7	15,3	14	4,8
6	1/2"	AMOD* 6 1/2	46,3	15,3	14	4,8
8	3/8"	AMOD* 8 3/8	42,0	16,2	14	7,9
8	1/2"	AMOD* 8 1/2	47,6	16,2	14	7,9
10	3/8"	AMOD* 10 3/8	43,1	17,2	17	7,9
10	1/2"	AMOD* 10 1/2	48,9	17,2	17	7,9
12	1/2"	AMOD* 12 1/2	52,2	22,8	22	9,5
12	3/4"	AMOD* 12 3/4	53,8	22,8	22	9,5
18	3/4"	AMOD* 18 3/4	56,1	24,4	27	12,7
18	1"	AMOD* 18 1"	62,4	24,4	27	12,7
25	1"	AMOD* 25 1"	70,1	31,3	36	19,1

*Specify material when ordering. See page 8 for materials and codes.

TUBE SIZE - FRACTIONAL TO METRIC - (inch)

d	D	Reference	A	E	H (mm)	P
1/8"	6	AMOD* 1/8 6	1.46	0.5	8	2.4

Hex flats (H) are metric. Fractional upon request
*Specify material when ordering. See page 8 for materials and codes.

MALE ADAPTOR | ADS

APPLICATION

Converts a female tapered-thread (NPT) end to a tube stem.

Special requirements on request

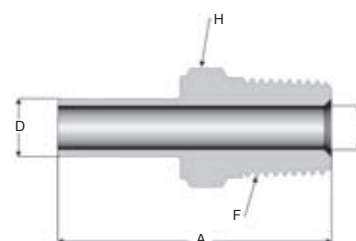

NPT (N)

TUBE SIZE - METRIC (mm)

D	F	Reference	A	H	P
4	1/8"	ADS* 4 1/8 N	28,6	12	3,2
4	1/4"	ADS* 4 1/4 N	34,1	14	3,2
6	1/8"	ADS* 6 1/8 N	31,0	14	4,8
6	1/4"	ADS* 6 1/4 N	35,7	14	4,8
6	3/8"	ADS* 6 3/8 N	36,5	19	4,8
6	1/2"	ADS* 6 1/2 N	42,1	22	4,8
8	1/8"	ADS* 8 1/8 N	31,8	14	4,8
8	1/4"	ADS* 8 1/4 N	37,3	14	6,4
8	3/8"	ADS* 8 3/8 N	37,3	19	6,4
10	1/8"	ADS* 10 1/8 N	33,3	17	4,8
10	1/4"	ADS* 10 1/4 N	38,1	17	7,9
10	3/8"	ADS* 10 3/8 N	38,1	19	7,9
10	1/2"	ADS* 10 1/2 N	43,7	22	7,9
12	1/4"	ADS* 12 1/4 N	42,9	14	7,1
12	3/8"	ADS* 12 3/8 N	43,7	19	9,5
12	1/2"	ADS* 12 1/2 N	49,2	22	9,5
14	3/8"	ADS* 14 3/8 N	45,2	19	7,1
16	3/8"	ADS* 16 3/8 N	45,2	19	9,5
16	1/2"	ADS* 16 1/2 N	50,8	22	11,9
16	3/4"	ADS* 16 3/4 N	50,8	27	12,7
20	3/4"	ADS* 20 3/4 N	54,0	27	15,9
22	3/4"	ADS* 22 3/4 N	54,0	27	15,9
25	3/4"	ADS* 25 3/4***	60,3	27	15,9

*Specify material when ordering. See page 8 for materials and codes.

TUBE SIZE - FRACTIONAL (inch)

D	F	Reference	A	H (mm)	P
1/8"	1/8"	ADS* 1/8 1/8 N	1.16	12	3/32"
1/8"	1/4"	ADS* 1/8 1/4 N	1.38	14	3/32"
3/16"	1/8"	ADS* 3/16 1/8 N	1.19	12	1/8"
3/16"	1/4"	ADS* 3/16 1/4 N	1.41	14	1/8"
1/4"	1/8"	ADS* 1/4 1/8 N	1.25	14	3/16"
1/4"	1/4"	ADS* 1/4 1/4 N	1.47	14	3/16"
1/4"	3/8"	ADS* 1/4 3/8 N	1.97	19	3/16"
1/4"	1/2"	ADS* 1/4 1/2 N	1.70	22	3/16"
5/16"	1/8"	ADS* 5/16 1/8 N	1.30	14	3/16"
5/16"	3/8"	ADS* 5/16 3/8 N	1.44	14	1/4
5/16"	1/4"	ADS* 5/16 1/4 N	1.50	14	1/4"
3/8"	1/8"	ADS* 3/8 1/8 N	1.33	17	3/16"
3/8"	1/4"	ADS* 3/8 1/4 N	1.53	17	9/32"
3/8"	3/8"	ADS* 3/8 3/8 N	1.56	19	9/32"
3/8"	1/2"	ADS* 3/8 1/2 N	1.78	22	9/32"
1/2"	1/4"	ADS* 1/2 1/4 N	1.75	14	9/32"
1/2"	3/8"	ADS* 1/2 3/8 N	1.78	19	3/8"
1/2"	1/2"	ADS* 1/2 1/2 N	2.00	22	13/32"
5/8"	1/2"	ADS* 5/8 1/2 N	2.06	22	15/32"
3/4"	1/2"	ADS* 3/4 1/2 N	2.06	22	15/32"
3/4"	3/4"	ADS* 3/4 3/4 N	2.06	27	5/8"
1"	3/4"	ADS* 1" 3/4 N	2.31	36	5/8"
1"	1"	ADS* 1" 1" N	2.61	36	7/8"

Hex flats (H) are metric. Fractional upon request
*Specify material when ordering. See page 8 for materials and codes.

MALE ADAPTOR | ADS

APPLICATION

Converts a female tapered-thread (BSPT) end to a tube stem.

Special requirements on request

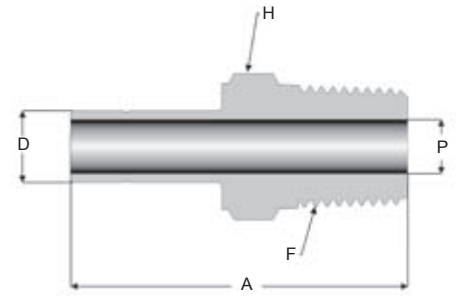

BSPT - ISO BSP Tapered Thread (T)

TUBE SIZE - METRIC (mm)

D	F	Reference	A	H	P
3	1/8"	ADS* 3 1/8 T	27,8	12	2,4
3	1/4"	ADS* 3 1/4 T	33,3	14	2,4
4	1/8"	ADS* 4 1/8 T	28,6	12	3,2
4	1/4"	ADS* 4 1/4 T	34,1	14	3,2
6	1/8"	ADS* 6 1/8 T	31,0	14	4,8
6	1/4"	ADS* 6 1/4 T	35,7	14	4,8
6	3/8"	ADS* 6 3/8 T	36,5	19	4,8
8	1/8"	ADS* 8 1/8 T	31,8	14	4,8
8	1/4"	ADS* 8 1/4 T	37,3	14	6,4
8	3/8"	ADS* 8 3/8 T	37,3	19	6,4
10	1/8"	ADS* 10 1/8 T	33,3	17	4,8
10	1/4"	ADS* 10 1/4 T	38,1	17	7,9
10	3/8"	ADS* 10 3/8 T	38,1	19	7,9
10	1/2"	ADS* 10 1/2 T	43,7	22	7,9
12	1/4"	ADS* 12 1/4 T	42,9	14	7,1
12	3/8"	ADS* 12 3/8 T	43,7	19	9,5
12	1/2"	ADS* 12 1/2 T	49,2	22	9,5
14	3/8"	ADS* 14 3/8 T	45,2	19	7,1
16	3/8"	ADS* 16 3/8 T	45,2	19	9,5
16	1/2"	ADS* 16 1/2 T	50,8	22	11,9
16	3/4"	ADS* 16 3/4 T	50,8	27	12,7
20	1/2"	ADS* 20 1/2 T	51,6	22	11,9
20	3/4"	ADS* 20 3/4 T	54,0	27	15,9
25	3/4"	ADS* 25 3/4 T	60,3	27	15,9

*Specify material when ordering. See page 8 for materials and codes.

TUBE SIZE - FRACTIONAL (inch)

D	F	Reference	A	H (mm)	P
1/8"	1/8"	ADS* 1/8 1/8 T	1.16	12	3/32"
1/8"	1/4"	ADS* 1/8 1/4 T	1.38	14	3/32"
1/4"	1/8"	ADS* 1/4 1/8 T	1.25	14	3/16"
1/4"	1/4"	ADS* 1/4 1/4 T	1.47	14	3/16"
1/4"	3/8"	ADS* 1/4 3/8 T	1.97	19	3/16"
1/4"	1/2"	ADS* 1/4 1/2 T	1.70	22	3/16"
5/16"	1/4"	ADS* 5/16 1/4 T	1.50	14	1/4"
3/8"	1/4"	ADS* 3/8 1/4 T	1.53	17	9/32"
3/8"	3/8"	ADS* 3/8 3/8 T	1.56	19	9/32"
3/8"	1/2"	ADS* 3/8 1/2 T	1.78	22	9/32"
1/2"	1/4"	ADS* 1/2 1/4 T	1.75	14	9/32"
1/2"	3/8"	ADS* 1/2 3/8 T	1.78	19	3/8"
1/2"	1/2"	ADS* 1/2 1/2 T	2.00	22	13/32"
3/4"	3/4"	ADS* 3/4 3/4 T	2.06	27	5/8"
1"	1"	ADS* 1" 1" T	2.61	36	7/8"

Hex flats (H) are metric. Fractional upon request
*Specify material when ordering. See page 8 for materials and codes.

MALE ADAPTOR | ADS

APPLICATION

Converts a female parallel thread (BSPP) end to a tube stem.

Special requirements on request

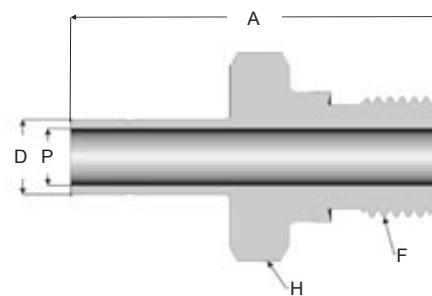

BSPP - ISO BSP Parallel Thread (G)

TUBE SIZE - METRIC (mm)

D	F	Reference	A	H	P
3	1/8"	ADS* 3 1/8 G	31,0	14	1,8
3	1/4"	ADS* 3 1/4 G	35,7	19	1,8
4	1/8"	ADS* 4 1/8 G	31,8	14	2,4
6	1/8"	ADS* 6 1/8 G	33,3	14	4,8
6	1/4"	ADS* 6 1/4 G	38,1	19	4,8
6	3/8"	ADS* 6 3/8 G	38,9	22	4,0
8	1/8"	ADS* 8 1/8 G	34,2	14	4,0
8	1/4"	ADS* 8 1/4 G	38,9	19	6,0
8	3/8"	ADS* 8 3/8 G	39,7	22	6,0
8	1/2"	ADS* 8 1/2 G	43,7	27	6,0
10	1/4"	ADS* 10 1/4 G	39,7	19	6,0
10	3/8"	ADS* 10 3/8 G	40,5	22	7,1
10	1/2"	ADS* 10 1/2 G	43,7	27	7,1
12	1/4"	ADS* 12 1/4 G	45,3	19	6,0
12	3/8"	ADS* 12 3/8 G	46,0	22	7,9
12	1/2"	ADS* 12 1/2 G	49,2	27	9,5
16	3/4"	ADS* 16 3/4 G	54,8	36	13,0

*Specify material when ordering. See page 8 for materials and codes.

TUBE SIZE - FRACTIONAL (inch)

D	F	Reference	A	H (mm)	P
1/8"	1/8"	ADS* 1/8 1/8 G	1.53	14	1/16"
1/8"	1/4"	ADS* 1/8 1/4 G	1.11	19	1/16"
1/4"	1/8"	ADS* 1/4 1/8 G	1.25	14	3/32"
1/4"	1/4"	ADS* 1/4 1/4 G	1.50	19	3/32"
1/4"	3/8"	ADS* 1/4 3/8 G	1.50	22	3/32"
3/8"	1/4"	ADS* 3/8 1/4 G	1.56	19	15/64"
3/8"	3/8"	ADS* 3/8 3/8 G	1.59	22	9/32"
1/2"	1/4"	ADS* 1/2 1/4 G	1.78	19	9/32"
1/2"	3/8"	ADS* 1/2 3/8 G	1.81	22	3/8"
3/4"	3/4"	ADS* 3/4 3/4 G	1.78	36	5/8"

Hex flats (H) are metric. Fractional upon request
*Specify material when ordering. See page 8 for materials and codes.

BSPP G end connections should be used with sealing gaskets.
See page 9 for further information. See page 59 for gaskets.

BSPP - ISO BSP Parallel Thread (K)

TUBE SIZE - FRACTIONAL (inch)

D	F	Reference	A	H	P
6	1/8"	ADS* 6 1/8 K	33,3	14	4,8
6	1/4"	ADS* 6 1/4 K	38,1	19	4,8
8	1/4"	ADS* 8 1/4 K	38,9	19	6
10	1/4"	ADS* 10 1/4 K	39,7	19	6
10	3/8"	ADS* 10 3/8 K	40,5	22	7,1
10	1/2"	ADS* 10 1/2 K	43,7	27	7,1
12	1/4"	ADS* 12 1/4 K	45,3	19	6
12	3/8"	ADS* 12 3/8 K	46,0	22	7,9
12	1/2"	ADS* 12 1/2 K	49,2	27	9,5

*Specify material when ordering. See page 8 for materials and codes.

TUBE SIZE - FRACTIONAL (inch)

D	F	Reference	A	H (mm)	P
1/4"	1/8"	ADS* 1/4 1/8 K	1.25	14	3/32"
1/4"	1/4"	ADS* 1/4 1/4 K	1.50	19	3/32"
1/4"	3/8"	ADS* 1/4 3/8 K	1.50	22	3/32"
1/4"	1/2"	ADS* 1/4 1/2 K	1.66	27	5/32"
3/8"	1/8"	ADS* 3/8 1/8 K	1.38	14	1/8"
3/8"	1/4"	ADS* 3/8 1/4 K	1.56	19	15/64"
3/8"	1/2"	ADS* 3/8 1/2 K	1.72	27	9/32"
1/2"	1/4"	ADS* 1/2 1/4 K	1.78	19	9/32"
1/2"	3/8"	ADS* 1/2 3/8 K	1.81	22	3/8"

Hex flats (H) are metric. Fractional upon request
*Specify material when ordering. See page 8 for materials and codes.

BSPP K end connections must be used with sealing gaskets.
See page 9 for further information. See page 59 for gaskets.

MALE ADAPTOR «AN» | ADS AN

APPLICATION

Converts a female AN thread end to a male tube stem.

Special requirements on request

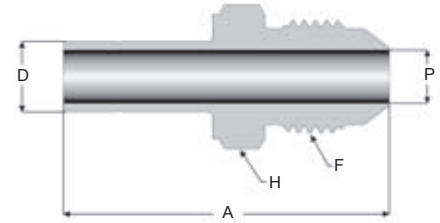

AN 37 (AN)

TUBE SIZE - METRIC (mm)

D	AN tube flare size	Reference	A	H	P	F
6	¼"	ADS* 6 ¼ AN	37,3	14	4,8	7/16" - 20
10	¼"	ADS* 10 ¼ AN	38,9	14	7,1	7/16" - 20
10	⅜"	ADS* 10 ⅜ AN	39,7	17	7,1	9/16" - 18
12	½"	ADS* 12 ½ AN	48,4	22	9,5	¾" - 16
18	¾"	ADS* 18 ¾ AN	56,4	27	9,5	1 1/16" - 12
25	1"	ADS* 25 1" AN	65,5	36	21,4	1 5/16" - 12

*Specify material when ordering. See page 8 for materials and codes.

TUBE SIZE - FRACTIONAL (inch)

D	AN tube flare size	Reference	A	H (mm)	P	F
¼"	¼"	ADS* ¼ ¼ AN	1 15/32"	14	3/16"	7/16" - 20
⅜"	¼"	ADS* ⅜ ¼ AN	1 17/32"	14	9/32"	7/16" - 20
⅜"	⅜"	ADS* ⅜ ⅜ AN	1 9/16"	17	9/32"	9/16" - 18
½"	½"	ADS* ½ ½ AN	1 29/32"	22	3/8"	¾" - 16
¾"	¾"	ADS* ¾ ¾ AN	2 7/32"	27	3/8"	1 1/16" - 12
1"	1"	ADS* 1" 1" AN	2 37/64"	36	7/8"	1 5/16" - 12

Hex flats (H) are metric. Fractional upon request
*Specify material when ordering. See page 8 for materials and codes.

MALE O-RING ADAPTOR «UN» | AOMSS

APPLICATION

Converts a female UN threaded end connection apparatus to a male tube stem.

Special requirements on request

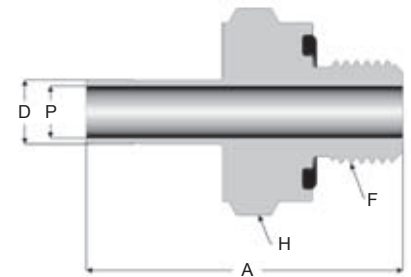

UN (UN)

TUBE SIZE - METRIC (mm)

D	F	Reference	A	H	P
3	5/16" - 24	AOMSS* 3 5/16	31,0	14	2,4
4	3/8" - 24	AOMSS* 4 3/8	32,5	17	3,2
6	7/16" - 20	AOMSS* 6 7/16	36,5	19	4,8
8	½" - 20	AOMSS* 8 ½	38,9	22	6,4
10	9/16" - 18	AOMSS* 10 9/16	40,5	24	8
12	¾" - 16	AOMSS* 12 ¾	46,8	30	9,5
16	7/8" - 14	AOMSS* 16 7/8	50,8	36	13
18	1 1/16" - 12	AOMSS* 18 1 1/16	53,2	38	15
20	1 1/16" - 12	AOMSS* 20 1 1/16	55,6	38	16
22	1 1/16" - 12	AOMSS* 22 1 1/16	55,6	38	18,5
25	1 5/16" - 12	AOMSS* 25 1 5/16	62,7	46	22

*Specify material when ordering. See page 8 for materials and codes.

TUBE SIZE - FRACTIONAL (inch)

D	F	Reference	A	H (mm)	P
1/8"	5/16" - 24	AOMSS* 1/8 5/16	1.22	14	3/32"
3/16"	3/8" - 24	AOMSS* 3/16 3/8	1.28	17	1/8"
1/4"	7/16" - 20	AOMSS* 1/4 7/16	1.44	19	3/16"
5/16"	½" - 20	AOMSS* 5/16 ½	1.53	22	¼"
3/8"	9/16" - 18	AOMSS* 3/8 9/16	1.59	24	5/16"
½"	¾" - 16	AOMSS* ½ ¾	1.84	30	13/32"

Hex flats (H) are metric. Fractional upon request
*Specify material when ordering. See page 8 for materials and codes.

UN fittings are supplied with sealing O-rings in Nitrile (NBR).
Fluorocarbon (FPM) O-rings are available upon request.
See page 8 for additional information.

MALE O-RING ADAPTOR «NPSM» | AOMS

TEESING

WWW.TEESING.COM

APPLICATION

Converts a female NPSM threaded end connection apparatus to a male tube stem.

Special requirements on request

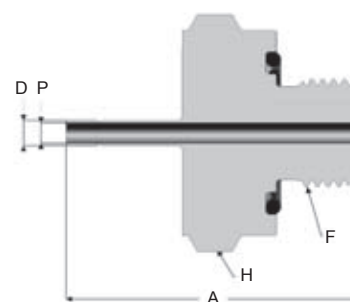

NPSM (NPSM)

TUBE SIZE - METRIC (mm)

D	F	Reference	A	H	P
6	1/8"	AOMS* 6 1/8	33,3	19	4,8
6	1/4"	AOMS* 6 1/4	36,5	24	4,8
6	3/8"	AOMS* 6 3/8	38,1	30	4,8
10	1/4"	AOMS* 10 1/4	38,1	24	7,1

NPSM fittings are supplied with sealing O-rings in Nitrile (NBR). Fluorocarbon (FPM) O-rings are available upon request. See page 8 for additional information.

*Specify material when ordering. See page 8 for materials and codes.

TUBE SIZE - FRACTIONAL (inch)

D	F	Reference	A	H (mm)	P
1/16"	1/8"	AOMS* 1/8 1/16	1.03	19	3/64"
1/8"	1/8"	AOMS* 1/8 1/8	1.22	19	3/32"
1/8"	1/4"	AOMS* 1/8 1/4	1.34	24	3/32"
3/16"	1/8"	AOMS* 3/16 1/8	1.25	19	1/8"
3/16"	1/4"	AOMS* 3/16 1/4	1.38	24	1/8"
1/4"	1/8"	AOMS* 1/4 1/8	1.31	19	3/16"
1/4"	1/4"	AOMS* 1/4 1/4	1.44	24	3/16"
1/4"	3/8"	AOMS* 1/4 3/8	1.50	30	3/16"
5/16"	1/8"	AOMS* 5/16 1/8	1.34	19	3/16"
5/16"	1/4"	AOMS* 5/16 1/4	1.47	24	1/4"
3/8"	1/8"	AOMS* 3/8 1/8	1.38	19	3/16"
3/8"	1/4"	AOMS* 3/8 1/4	1.50	24	9/32"
3/8"	3/8"	AOMS* 3/8 3/8	1.56	30	9/32"
1/2"	3/8"	AOMS* 1/2 3/8	1.78	30	13/32"
5/8"	1/2"	AOMS* 5/8 1/2	2.06	36	1/2"
3/4"	3/4"	AOMS* 3/4 3/4	2.16	41	5/8"
1"	1"	AOMS* 1" 1"	2.56	46	7/8"

Hex flats (H) are metric. Fractional upon request

*Specify material when ordering. See page 8 for materials and codes.

FEMALE ADAPTOR | AFS

APPLICATION

Converts a male tapered-thread (NPT) end to a tube stem.

Special requirements on request

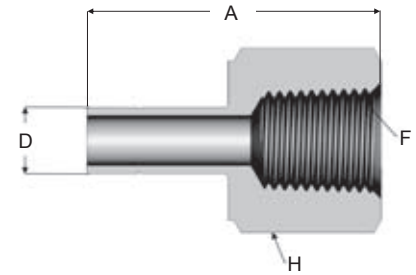

NPT (N)

TUBE SIZE - METRIC (mm)

D	F	Reference	A	H
3	1/8"	AFS* 3 1/8 N	27,0	14
3	1/4"	AFS* 3 1/4 N	31,8	19
4	1/8"	AFS* 4 1/8 N	27,8	14
4	1/4"	AFS* 4 1/4 N	32,5	19
6	1/8"	AFS* 6 1/8 N	29,4	14
6	1/4"	AFS* 6 1/4 N	34,1	19
6	3/8"	AFS* 6 3/8 N	35,7	22
6	1/2"	AFS* 6 1/2 N	40,5	27
8	1/8"	AFS* 8 1/8 N	30,2	14
8	1/4"	AFS* 8 1/4 N	34,9	19
8	3/8"	AFS* 8 3/8 N	36,5	22
8	1/2"	AFS* 8 1/2 N	41,3	27
10	1/8"	AFS* 10 1/8 N	31,0	14
10	1/4"	AFS* 10 1/4 N	35,7	19
10	3/8"	AFS* 10 3/8 N	37,3	22
10	1/2"	AFS* 10 1/2 N	42,1	27
12	1/4"	AFS* 12 1/4 N	41,3	19
12	3/8"	AFS* 12 3/8 N	42,9	22
12	1/2"	AFS* 12 1/2 N	47,6	27
14	3/8"	AFS* 14 3/8 N	44,5	22
14	1/2"	AFS* 14 1/2 N	49,2	27
14	3/4"	AFS* 14 3/4 N	51,6	32
16	3/8"	AFS* 16 3/8 N	44,5	22
16	1/2"	AFS* 16 1/2 N	49,2	27
16	3/4"	AFS* 16 3/4 N	51,6	32
18	1/2"	AFS* 18 1/2 N	49,2	27
18	3/4"	AFS* 18 3/4 N	51,5	32
18	1"	AFS* 18 1" N	60,3	41
22	3/4"	AFS* 22 3/4 N	52,4	32
25	3/4"	AFS* 25 3/4 N	58,8	32
25	1"	AFS* 25 1" N	67,5	41

*Specify material when ordering. See page 8 for materials and codes.

TUBE SIZE - FRACTIONAL (inch)

D	F	Reference	A	H (mm)
1/8"	1/8"	AFS* 1/8 1/8 N	1.06	14
1/8"	1/4"	AFS* 1/8 1/4 N	1.25	19
3/16"	1/8"	AFS* 3/16 1/8 N	1.09	14
3/16"	1/4"	AFS* 3/16 1/4 N	1.28	19
1/4"	1/8"	AFS* 1/4 1/8 N	1.16	14
1/4"	1/4"	AFS* 1/4 1/4 N	1.34	19
1/4"	3/8"	AFS* 1/4 3/8 N	1.41	22
1/4"	1/2"	AFS* 1/4 1/2 N	1.59	27
5/16"	1/8"	AFS* 5/16 1/8 N	1.19	14
5/16"	1/4"	AFS* 5/16 1/4 N	1.38	19
5/16"	3/8"	AFS* 5/16 3/8 N	1.44	22
5/16"	1/2"	AFS* 5/16 1/2 N	1.63	27
3/8"	1/8"	AFS* 3/8 1/8 N	1.22	17
3/8"	1/4"	AFS* 3/8 1/4 N	1.41	19
3/8"	3/8"	AFS* 3/8 3/8 N	1.47	22
3/8"	1/2"	AFS* 3/8 1/2 N	1.66	27
1/2"	1/4"	AFS* 1/2 1/4 N	1.63	22
1/2"	3/8"	AFS* 1/2 3/8 N	1.69	22
1/2"	1/2"	AFS* 1/2 1/2 N	1.88	27
5/8"	3/8"	AFS* 5/8 3/8 N	1.75	24
5/8"	1/2"	AFS* 5/8 1/2 N	1.94	27
5/8"	3/4"	AFS* 5/8 3/4 N	2.03	32
3/4"	1/2"	AFS* 3/4 1/2 N	1.94	27
3/4"	3/4"	AFS* 3/4 3/4 N	2.03	32
3/4"	1"	AFS* 3/4 1" N	2.38	41
7/8"	3/4"	AFS* 7/8 3/4 N	2.06	32
1"	3/4"	AFS* 1" 3/4 N	2.31	36
1"	1"	AFS* 1" 1" N	2.66	41

Hex flats (H) are metric. Fractional upon request
*Specify material when ordering. See page 8 for materials and codes.

FEMALE ADAPTOR | AFS

APPLICATION

Converts a male tapered-thread (BSPT) end to a tube stem.

Special requirements on request

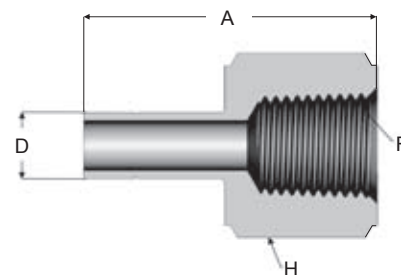

BSPT - ISO BSP Tapered Thread (T)

TUBE SIZE - METRIC (mm)

D	F	Reference	A	H
3	1/8"	AFS* 3 1/8 T	27,0	14
3	1/4"	AFS* 3 1/4 T	31,8	19
4	1/8"	AFS* 4 1/8 T	27,8	14
4	1/4"	AFS* 4 1/4 T	32,5	19
6	1/8"	AFS* 6 1/8 T	29,4	14
6	1/4"	AFS* 6 1/4 T	34,1	19
6	3/8"	AFS* 6 3/8 T	35,7	22
6	1/2"	AFS* 6 1/2 T	40,5	27
8	1/8"	AFS* 8 1/8 T	30,2	14
8	1/4"	AFS* 8 1/4 T	34,9	19
8	3/8"	AFS* 8 3/8 T	36,5	22
8	1/2"	AFS* 8 1/2 T	41,3	27
10	1/4"	AFS* 10 1/4 T	35,7	19
10	3/8"	AFS* 10 3/8 T	37,3	22
10	1/2"	AFS* 10 1/2 T	42,1	27
12	1/4"	AFS* 12 1/4 T	41,3	19
12	3/8"	AFS* 12 3/8 T	42,9	22
12	1/2"	AFS* 12 1/2 T	47,6	27
14	3/8"	AFS* 14 3/8 T	44,5	22
16	3/8"	AFS* 16 3/8 T	44,5	22
16	1/2"	AFS* 16 1/2 T	49,2	27
18	1/2"	AFS* 18 1/2 T	49,2	27
18	3/4"	AFS* 18 3/4 T	51,5	32
22	3/4"	AFS* 22 3/4 T	52,4	32
25	1"	AFS* 25 1" T	67,5	41

*Specify material when ordering. See page 8 for materials and codes.

TUBE SIZE - FRACTIONAL (inch)

D	F	Reference	A	H (mm)
1/8"	1/8"	AFS* 1/8 1/8 T	1.06	14
1/8"	1/4"	AFS* 1/8 1/4 T	1.25	19
3/16"	1/8"	AFS* 3/16 1/8 T	1.09	14
3/16"	1/4"	AFS* 3/16 1/4 T	1.28	19
1/4"	1/8"	AFS* 1/4 1/8 T	1.16	14
1/4"	1/4"	AFS* 1/4 1/4 T	1.34	19
1/4"	3/8"	AFS* 1/4 3/8 T	1.41	22
1/4"	1/2"	AFS* 1/4 1/2 T	1.59	27
5/16"	1/8"	AFS* 5/16 1/8 T	1.19	14
5/16"	1/4"	AFS* 5/16 1/4 T	1.38	19
5/16"	3/8"	AFS* 5/16 3/8 T	1.44	22
5/16"	1/2"	AFS* 5/16 1/2 T	1.63	27
3/8"	1/8"	AFS* 3/8 1/8 T	1.22	17
3/8"	1/4"	AFS* 3/8 1/4 T	1.41	19
3/8"	3/8"	AFS* 3/8 3/8 T	1.47	22
3/8"	1/2"	AFS* 3/8 1/2 T	1.66	27
1/2"	1/4"	AFS* 1/2 1/4 T	1.63	22
1/2"	3/8"	AFS* 1/2 3/8 T	1.69	22
1/2"	1/2"	AFS* 1/2 1/2 T	1.88	27
5/8"	3/8"	AFS* 5/8 3/8 T	1.75	24
5/8"	1/2"	AFS* 5/8 1/2 T	1.94	27
5/8"	3/4"	AFS* 5/8 3/4 T	2.03	32
3/4"	1/2"	AFS* 3/4 1/2 T	1.94	27
3/4"	3/4"	AFS* 3/4 3/4 T	2.03	32
3/4"	1"	AFS* 3/4 1" T	2.38	41
7/8"	3/4"	AFS* 7/8 3/4 T	2.06	32
1"	3/4"	AFS* 1" 3/4 T	2.31	36
1"	1"	AFS* 1" 1" T	2.66	41

Hex flats (H) are metric. Fractional upon request

*Specify material when ordering. See page 8 for materials and codes.

FEMALE ADAPTOR | AFS

APPLICATION

Converts a male parallel thread (BSPP) end to a tube stem.

Special requirements on request

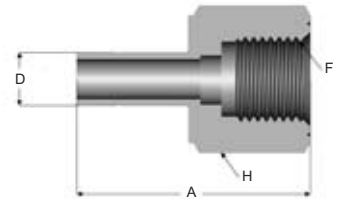

BSPP - ISO BSP Parallel Thread (G)

TUBE SIZE - METRIC (mm)

D	F	Reference	A	H
3	1/4"	AFS* 3 1/4 G	33,5	19
6	1/8"	AFS* 6 1/8 G	29,4	14
6	1/4"	AFS* 6 1/4 G	34,1	19
6	3/8"	AFS* 6 3/8 G	35,7	22
6	1/2"	AFS* 6 1/2 G	40,5	27
8	1/4"	AFS* 8 1/4 G	34,9	19
8	3/8"	AFS* 8 3/8 G	36,5	22
8	1/2"	AFS* 8 1/2 G	41,3	27
10	1/8"	AFS* 10 1/8 G	30,95	14
10	1/4"	AFS* 10 1/4 G	35,7	19
10	3/8"	AFS* 10 3/8 G	37,3	22
10	1/2"	AFS* 10 1/2 G	42,1	27
12	1/4"	AFS* 12 1/4 G	41,3	19
12	1/2"	AFS* 12 1/2 G	47,6	27
14	3/8"	AFS* 14 3/8 G	42,9	22
16	3/8"	AFS* 16 3/8 G	44,5	22
16	1/2"	AFS* 16 1/2 G	49,2	27
18	1/2"	AFS* 18 1/2 G	49,2	27
18	3/4"	AFS* 18 3/4 G	51,6	32
22	3/4"	AFS* 22 3/4 G	52,4	32

*Specify material when ordering. See page 8 for materials and codes.

TUBE SIZE - FRACTIONAL (inch)

D	F	Reference	A	H (mm)
1/8"	1/4"	AFS* 1/8 1/4 G	1.25	19
1/4"	1/4"	AFS* 1/4 1/4 G	1.34	19
1/4"	3/8"	AFS* 1/4 3/8 G	1.41	22
1/4"	1/2"	AFS* 1/4 1/2 G	1.59	27
5/16"	1/4"	AFS* 5/16 1/4 G	1.38	19
5/16"	1/2"	AFS* 5/16 1/2 G	1.63	27
3/8"	1/4"	AFS* 3/8 1/4 G		19
3/8"	3/8"	AFS* 3/8 3/8 G	1.47	22
3/8"	1/2"	AFS* 3/8 1/2 G	1.66	27
1/2"	1/4"	AFS* 1/2 1/4 G	1.63	19
1/2"	1/2"	AFS* 1/2 1/2 G	1.88	27
5/8"	1/2"	AFS* 5/8 1/2 G	1.94	27
3/4"	1/2"	AFS* 3/4 1/2 G	1.94	27
1"	3/4"	AFS* 1 3/4 G	2.31	32

Hex flats (H) are metric. Fractional upon request
*Specify material when ordering. See page 8 for materials and codes.

BSPP G end connections should be used with sealing gaskets.
See page 9 for further information. See page 59 for gaskets.

FEMALE ADAPTOR «AN» | AFS AN



Note that the ferrules are already pre-swaged on the fitting, that means you have to use the re-assembling instructions.

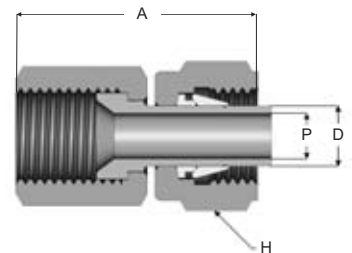

AN 37 (AN)

TUBE SIZE - METRIC (mm)

D	AN tube flare size	Reference	A	H	P	F
3	1/8"	AFS* 3 1/8 AN	27	12	1,6	5/16" - 24
3	1/4"	AFS* 3 1/4 AN	29,4	12	2,4	7/16" - 20
4	3/16"	AFS* 4 3/16 AN	30,2	12	3,2	3/8" - 24
6	1/4"	AFS* 6 1/4 AN	31,8	14	4,4	7/16" - 20
8	5/16"	AFS* 8 5/16 AN	33,4	17	5,9	1/2" - 20
10	3/8"	AFS* 10 3/8 AN	35,8	19	9,9	9/16" - 18
12	1/2"	AFS* 12 1/2 AN	44,4	22	9,9	3/4" - 16
16	5/8"	AFS* 16 5/8 AN	49,2	27	12,3	7/8" - 14
25	1"	AFS* 25 1" AN	60,4	38	21,4	1 5/16" - 12

*Specify material when ordering. See page 8 for materials and codes.

TUBE SIZE - FRACTIONAL (inch)

D	AN tube flare size	Reference	A (mm)	H (mm)	P	F
1/8"	1/8"	AFS* 1/8 1/8 AN	1.06	12	1/16"	5/16" - 24
1/8"	1/4"	AFS* 1/8 1/4 AN	1.16	12	3/32"	7/16" - 20
1/4"	1/4"	AFS* 1/4 1/4 AN	1.25	14	1/64"	7/16" - 20
3/8"	3/8"	AFS* 3/8 3/8 AN	1.41	19	19/64"	9/16" - 18
1/2"	1/2"	AFS* 1/2 1/2 AN	1.75	22	25/64"	3/4" - 16
1"	1"	AFS* 1 1" AN	2.38	38	27/32"	1 5/16" - 12

Hex flats (H) are metric. Fractional upon request
*Specify material when ordering. See page 8 for materials and codes.